

CLAMP

BK/BS
SERIES

Magnetic Sensor

BK

Clamp is designed for mounting CS-05 & CS-15 series sensor on round cylinder.

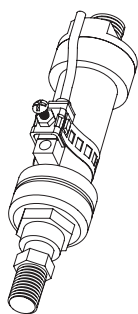
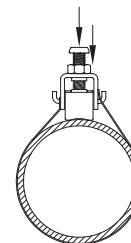
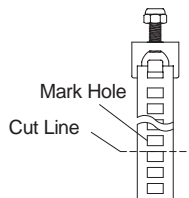
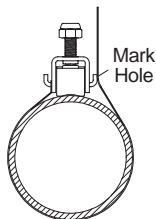
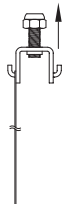
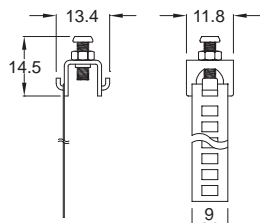

Step 1
Loosen screw & nut.

Step 2
Place sensor & wrap the band around the cylinder. Position the hook with the nearest hole on the band and mark the hole with a permanent marker.

Step 3
Remove mounting assembly. Cut the band at the nearest edge of next hole. (the one that's further away from the mounting head).

Step 4
Re-place the sensor & mounting assembly. Wrap the band & put the chosen hole on hook. Position the switch and tighten. Finally swivel nut for steadying.

BK-81 : For $\varnothing 6 \sim \varnothing 32$ round cylinder use.
BK-82 : For $\varnothing 6 \sim \varnothing 63$ round cylinder use.

BS

Clamp is designed for mounting CS-48 series sensor on round cylinder.

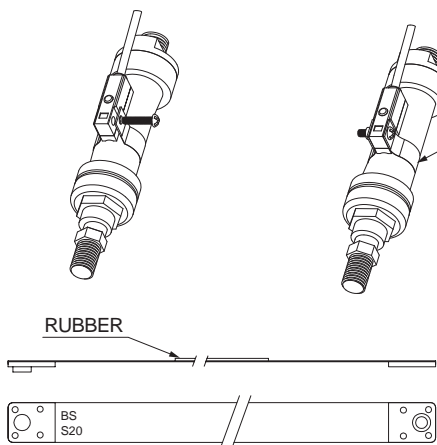

Wrap the band around cylinder barrel and re-insert screw head into clamp. Position the switch and tighten.

BS - **S** **2** **5**

- 12 : $\varnothing 12$ cylinder
- 16 : $\varnothing 16$ cylinder
- ...
- 40 : $\varnothing 40$ cylinder

S : For cylinder body is stainless steel.
A : For cylinder body is aluminum alloy.

EX : **BS-S25** : It is used on $\varnothing 25$ cylinder and material of cylinder tube is stainless.

Cylinder Chart

Model	Bore Size	Barrel Material	O.D. (mm)	Model	Bore Size	Barrel Material	O.D. (mm)
BS-A20	$\varnothing 20$	Aluminum	25	BS-S6	$\varnothing 6$	Stainless	8.5
BS-A25	$\varnothing 25$	Aluminum	30	BS-S8	$\varnothing 8$	Stainless	10
BS-A30	$\varnothing 30$	Aluminum	35	BS-S10	$\varnothing 10$	Stainless	11
BS-A32	$\varnothing 32$	Aluminum	37	BS-S12	$\varnothing 12$	Stainless	13.2
BS-A40	$\varnothing 40$	Aluminum	45	BS-S16	$\varnothing 16$	Stainless	17
BS-A50	$\varnothing 50$	Aluminum	55	BS-S20	$\varnothing 20$	Stainless	21.6
BS-A63	$\varnothing 63$	Aluminum	70	BS-S25	$\varnothing 25$	Stainless	26.5
BS-A80	$\varnothing 80$	Aluminum	87.7	BS-S32	$\varnothing 32$	Stainless	33.6
				BS-S40	$\varnothing 40$	Stainless	42